



C.F.R. S.r.l.
Modena - Italy

POTENZA
POWER
200 W

TENSIONE
TENSION
24 V

VELOCITA'
SPEED
2000 Rpm

COPPIA
TORQUE
0.95 Nm

PROTEZIONE
ENCLOSURE
IP **44**

PESO
WEIGHT
5 Kg

CODICE
CODE
MP102.S0002
DATA
DATE
30/03/2009

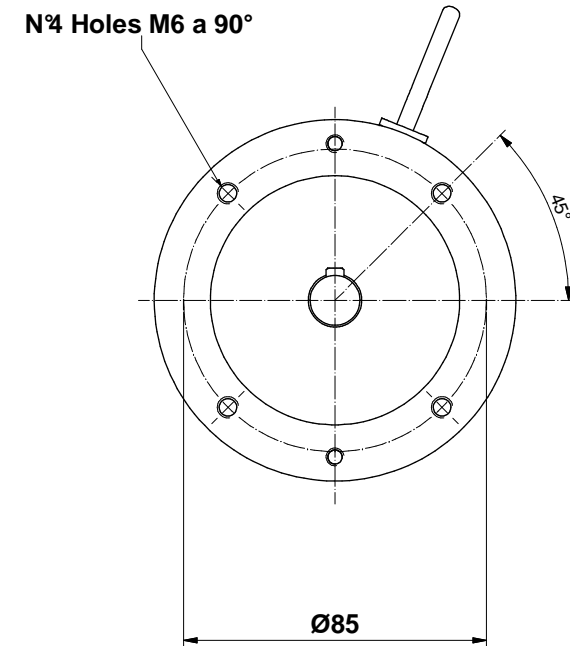
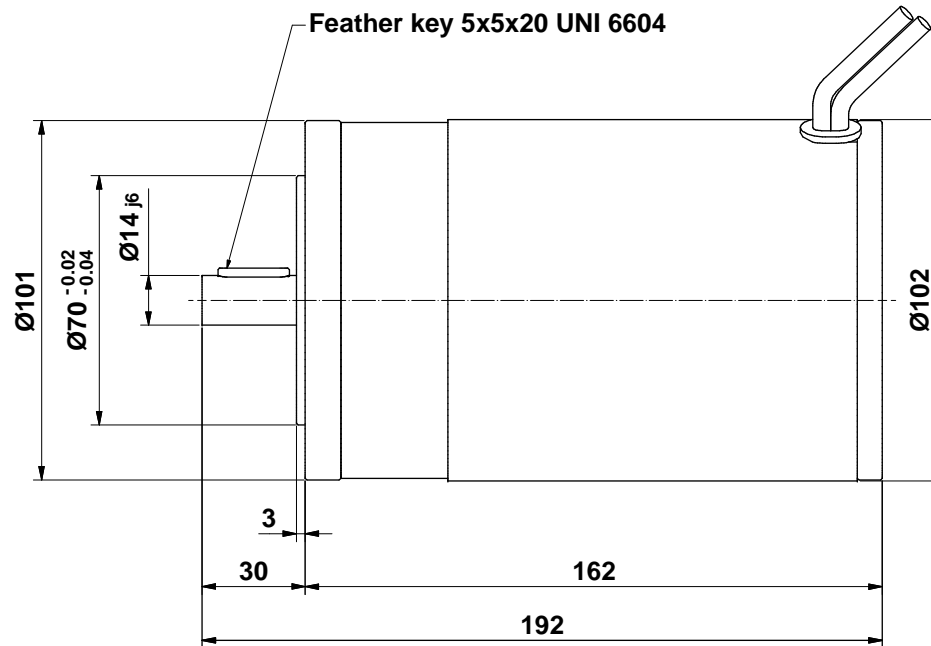

PERMANENT MAGNET MOTOR

Scala : 1 : 1.5
Scale :

