

## PL-A PL Plastic Enclosure (Waterproof/dustproof structure)



Light weight and environment-friendly enclosure made of resin with a key and a highly airtight structure of IP65

[Non-halogen flame retardant resin which is adapted to RoHS]

Paint Color	Light beige (6Y7/1)
Material	PC+ABS resin
Mounting plate	Wood mounting plate (15mm)
Application / IP grade	Indoor/Outdoor IP65
Thickness	Door Body:3.0mm~4.0mm
Handle	Small waterproof handle (Key No. N200)
Door type	Single swing door



PL16-33A

PL20-45A

PL20-565A

### Features

- Highly airtight dustproof and waterproof capacities of IP65
- May be used at the outdoor as well.
- Excellent electric wave penetration capacity that allows accommodating wireless LAN device, etc.
- Employment of highly sturdy flame retardant resin
- It can be locked. (Key No. N200)

### Capable of accommodating various kinds of device!

- Communication device for broad band
- Wireless LAN access point
- Peripheral equipment for monitoring camera
- Community antenna TV equipment
- Power supply breaker, terminal board, etc.

Outline drawing

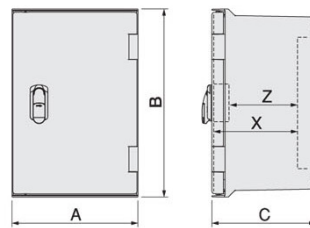

Body drawing

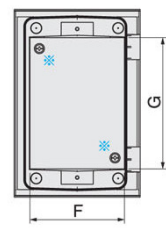

※ PL12-23A, PL16-23A

PL12-23A and PL16-23A are fixed at 2 places. Otherwise, it is fixed at 4 places.

Unit / mm

Product number	Number of handles	Outside dimensions			Wood mounting plate dimensions		Available depth X	Handle section Available depth Z	Product weight kg
		W A	H B	D C	W F	H G			
<b>PL10-45A</b>	2	400	500	100	350	400	65	33	4.7
<b>PL12-23A</b>	1	200	300	120	150	210	87	54	1.7
<b>PL16-23A</b>	1	"	"	165	"	"	132	99	1.8
<b>PL16-33A</b>	1	300	"	"	250	"	"	"	2.4
<b>PL16-34A</b>	2	"	400	"	"	300	131	"	3.4
<b>PL16-35A</b>	2	"	500	"	"	400	"	"	4.1
<b>PL16-43A</b>	1	400	300	"	350	200	"	"	3.1
<b>PL16-54A</b>	2	500	400	"	450	300	"	"	5.1
<b>PL20-24A</b>	2	200	"	200	150	"	167	134	2.6
<b>PL20-34A</b>	2	300	"	"	250	"	166	"	3.6
<b>PL20-44A</b>	2	400	"	"	350	"	"	"	4.5
<b>PL20-45A</b>	2	"	500	"	"	400	165	133	5.4
<b>PL20-55A</b>	2	500	"	"	420	390	164	126.5	6.9
<b>PL20-565A</b>	3	"	650	"	"	540	"	"	8.5

● Stock in Japan



[Example of accommodation of wireless antenna]

[Example of accommodation of wireless antenna]

[Example of accommodation of HUB]